

FIFE COUNCIL



FORTH VIEW, KIRKALDY

PROPERTY KEY FACTS

Three blocks of 47 flats (1 and 2-bed), over 8 storeys, built in 1956. Upgrade including EWI in 2019.

Energy performance features:

Walls: system built, with external insulation.

Windows: fully double glazed.

Roof: another dwelling above/below.

Floor: another dwelling above/below.

Previous system: electric storage heaters.

THE PROJECT

Fife Council was keen to upgrade the heating in its three Forth View tower blocks and selected the Ambion low-carbon system to replace storage heaters. The fabric of the blocks was also upgraded with EWI.

After several years' successful operation, in October 2023 the Council selected the Ambion system for Swann and Memorial Court (see below) as part of a £4.5m general upgrade, including EWI.



AMBION SPECIFICATION: 2-bed flat

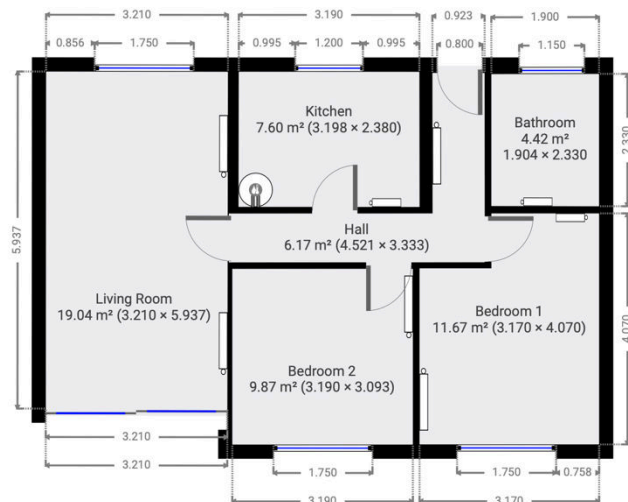

Total area: 58.7m<sup>2</sup>

5 x large heat panels (820 W):

3 x small heat panels (430 W):

1 x control panel

Total system power: 5.39 Kw (91.8 W/m<sup>2</sup>)

BENEFITS

Residents enjoy 24-hour thermal comfort at a typical running cost of £47.36 per month for a 2-bed flat (2,105 kWh per annum at 27 p/kWh). Residents enjoy good air quality with minimum condensation and reduced dust.

For Fife Council, the Ambion system is a key component within the successful upgrade of tower blocks.

“The programme of works [for Swann and Memorial Court] makes a positive contribution to the council’s refreshed Climate Change Plan and the Local Housing Strategy by improving the energy efficiency...and reducing fuel poverty within the blocks.” Fife Council