

HALTON HOUSING



MONTGOMERY ROAD, WIDNES

PROPERTY KEY FACTS

Six two-bedroom and two three-bedroom new homes, built using modern methods of construction (MMC).

Built for affordable rent.

Energy performance features:

Walls: average thermal transmittance 0.19 W/m²K.

Roof: average thermal transmittance 0.16 W/m²K.

Floor: average thermal transmittance 0.13 W/m²K.

Windows: high performance glazing.

Air tightness: Air permeability 5.5 m³/h.m² (as tested).

Annual heat demand: 2,319 kWh pa (EPC).

THE PROJECT

Halton Housing is an award-winning housing association known for its innovative approach. With over 7,000 homes across Runcorn and Widnes in Cheshire, Halton is also expanding geographically across the North West.

Halton is a Board Member on 'Building Better', a consortium of housing associations working together to realise the benefits of MMC, embracing a range of offsite manufacturing and onsite techniques that provide alternatives to traditional house building.

Halton selected Ambion low-carbon heating technology as part of its forward-looking approach. With its easy install, the Ambion system aligned with the MMC approach.

AMBION SPECIFICATION: 3-bed house

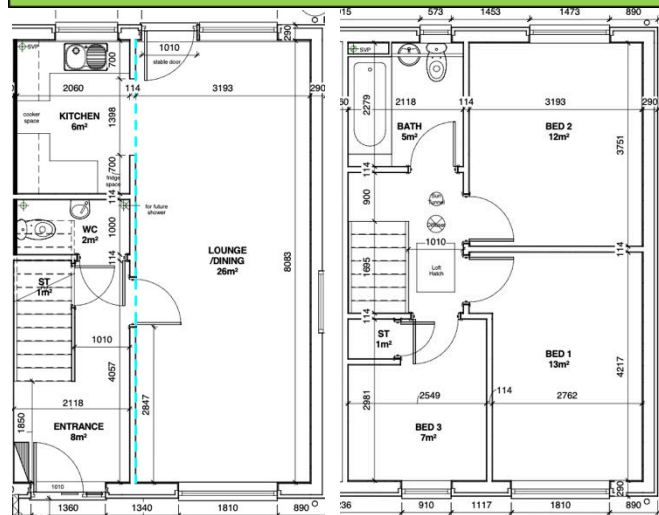

Total area: 85.0 m²

7 x large heat panels (820 W):

4 x small heat panels (430 W):

1 x control panel

Total system power: 7.46 Kw (87.7 W/m²)

BENEFITS

Residents enjoy 24-hour thermal comfort at a typical running cost of £32.81 per month for a 3-bed house (1,607 kWh per annum at 24.5 p/kWh). Residents enjoy good air quality with minimum condensation and reduced dust.

For Halton Housing, the Ambion system was a key component of the MMC construction, with the advantage of no on-going maintenance costs.